



USER MANUAL

Helmet Bluetooth Earphone

EJEAS

Q www.ejeas.com

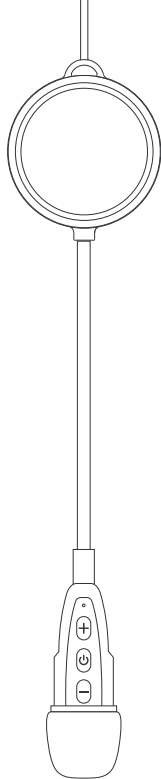
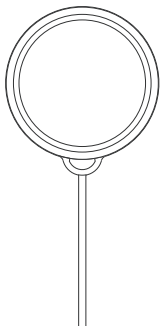

Product Details

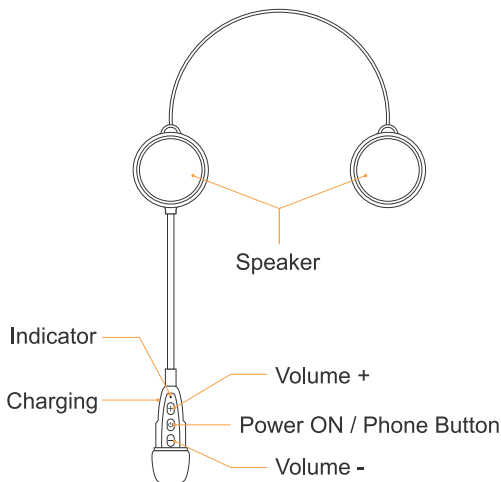

Product Installation

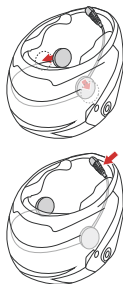

- 1 Stick the E1+ on both sides inside the helmet.
(The Velcro is replaceable)
- 2 Adjust the Mic position for a better fit.

Product Operations

Operation Diagram

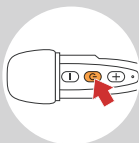

Single-click

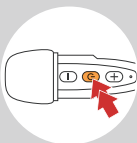

Double-click

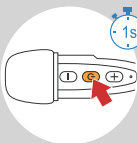

Long-press
for 1s

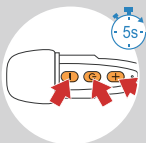

Simultaneously
press for 5s

Basic Operations

Power ON/OFF Please charge before using.



ON ? "Ding~Ding~Ding~Ding~"
Standby • Blue light flashes slow

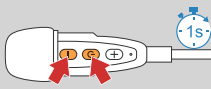

OFF Press the <Volume -> & <Phone
button> simultaneously for 1s.
• Indicator lights off

Low Battery Indication

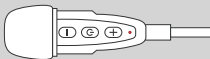

• Red light quickly flashes twice
? "Low battery"

Charging Indication

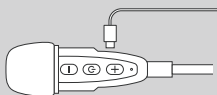

Charging • Red light always on
Full • Red light off

Volume Control



Factory Reset

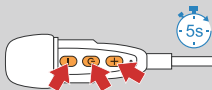

Long press the <Volume +>, <Volume ->, <Phone button> for 5s at the same time.

- The red and blue lights quickly flash four times simultaneously

? "Do~Do~"

Bluetooth Pairing

Phone Pairing

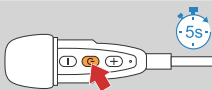

① When standby, long-press the <Phone button> for 5s.

(If no paired, will exit the pairing within 2min)

- Red and Blue light flash quickly

? "Pairing"



② Turn on the "Bluetooth" of cellphone, find and pair the E1+.

Pairing Successful

- Blue light slow flashes twice

? "Pairing Successful"

"Connected"



Current battery status will show on the cellphone

(The cellphone must support HFP)

Phone Reconnection

Power ON the E1+, it will auto reconnect to the cellphone

or



Mobile Phone

Answer a Call

Auto answering within 8s
if no other action taken

or



Reject a Call

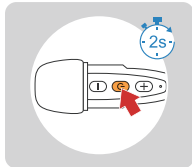

Last Call Replay

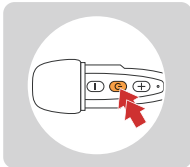

End a Call

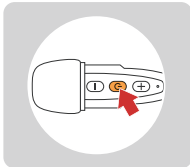

TEL Priority When listen to music, and receive a phone call.

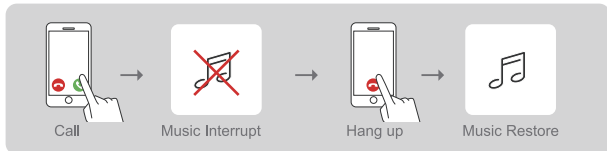

Voice Assistant Phone must support the voice assistant (Google assistant & Siri).

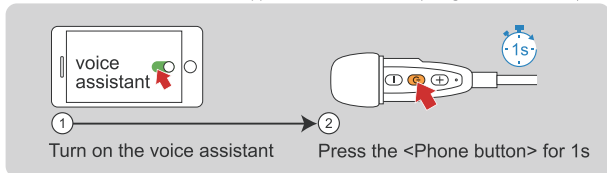

Music Control

Music Play/Pause

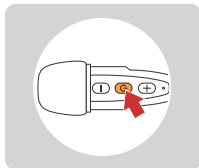

Music Switching

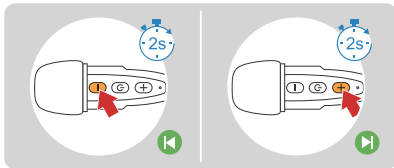

SafeRiding APP

The EJEAS SafeRiding App allows you to set up your group and stay connected with your friends. Save time and enjoy your adventure even more! You can also see more product operations precautions and multiple language operations! Download the EJEAS SafeRiding App for Android and Apple operating systems from ejeas.com/support.

SafeRiding
APP



iOS



Andriod

NOTE: This equipment has been tested and found to comply with the limits for a Class B digital device, pursuant to part 15 of the FCC Rules. These limits are designed to provide reasonable protection against harmful interference in a residential installation. This equipment generates uses and can radiate radio frequency energy and, if not installed and used in accordance with the instructions, may cause harmful interference to radio communications. However, there is no guarantee that interference will not occur in a particular installation. If this equipment does cause harmful interference to radio or television reception, which can be determined by turning the equipment off and on, the user is encouraged to try to correct the interference by one or more of the following measures:

- Reorient or relocate the receiving antenna.
- Increase the separation between the equipment and receiver.
- Connect the equipment into an outlet on a circuit different from that to which the receiver is connected.
- Consult the dealer or an experienced radio/TV technician for help

Changes or modifications not expressly approved by the party responsible for compliance could void the user's authority to operate the equipment. This device complies with Part 15 of the FCC Rules. Operation is subject to the following two conditions:

- (1) this device may not cause harmful interference, and
- (2) this device must accept any interference received, including interference that may cause undesired operation

EJEAS[®]