

EJEAS-E6 PLUS



www.EJEAS.com

User Manual

The illustration:



- 1: Power on
- 2: RESET/Power off
- 3: Phone/play
- 4: Volume+
- 5: Volume -
- 6: Rider B
- 7: Rider C
- 8: Rider D/Function
- 9: Rider E/Function



10: Charging interface /AUX port

11: Headset interface



12: Deck

Installation instruction

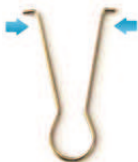

1



2

Clip installation Step1:Pinch clip buckel,fasten it



3



4

Clip installation Step 2:Another side make same as Step 1



Open the clamp, clamp edge of the helmet



Pinch clip buckle, and take it off



Install bluetooth intercom into the clip under instruction



Finished installation



The location of the installation of headphones and mic



Earphone line connecting instruction

Power on/Power off

【 Power on】 : Long press the Power key for about 2s, the blue lights, voice prompt "power on".

【Power Off】 : Press the Power key and the Phone key at the same time about 0.2s, red light, voice prompt "power off", or short press the Reset key.

Pair with cellphone/MP3/GPS:

Long press phone button about 6 second , searching and pairing E6 PLUS on phone , blue light flshing when connect susccessfully.

Paired phone if there if there is a need to reconnect the E6 PLUS successfully :

It will boot automatically connect mobile phone once you power on, if not connected ,short press the phone button,it will reconnect a mobile phone again.

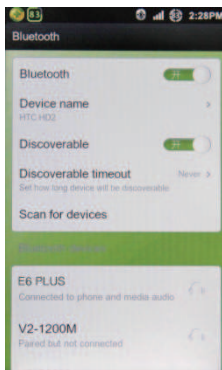

The bluetooth host for mobile phone operation:

【Answer calls】 : When calling , not operation in 8s, E6 PLUS will automatically be answered after 8s. or short press PHONE key to answer the phone call.

【Refused to call】 :Phone calls with in 5 seconds, Double click host Phone key. refused to Call.

【End call】 : In the process of the phone calls , short press Phone key, end phone calls.

【Replay the end code】 : When connected with phone status, double click the volume “-” key, voice prompt Redialing, replay cellphone records call number for last time automatically.

【voice dial】 :When connected with phone status, double click the volume “+” button, enter the voice dialing mode.

【Music control】 :Short press Phone key, mobile music can play or suspended.

【Volume control】 :During communication intercom, mobile phone call or play music, short press the “+” volume key, to increase the volume, short press “-” volume key,reduce the volume. After adjust the volume, press the power bottom can save the record.

【Next music】 :Double click volume “+” button, you can jump to a next piece of music.

【Ahead music】 :Double click volume “-” button, you can jump to ahead piece of music.

E6 PLUS pairing instuction

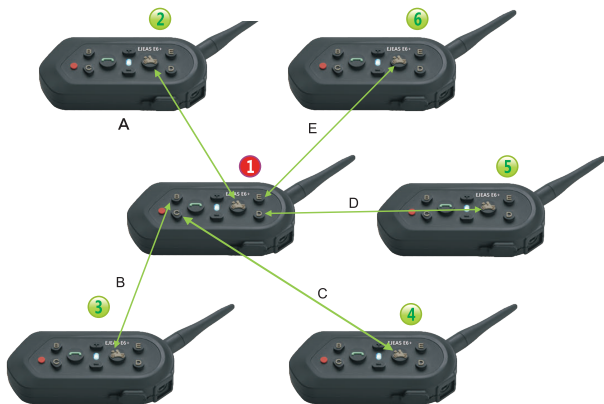

E6 PLUS pairing steps , realize the two switch intercom:

1. A group match

Press the power buttons of the host and A intercom at the same time (about 5 seconds) , to see the host and the A intercom's red and blue lights flashing and then released. Press the A button of the host, start searching , after pairing successful, 2 radios are only the blue light flashing, the two intercom are paired, and after pairing, press one of the pairing button to enter into the communication status and save the pairing record.

2. B group match

Power on state, long press the B button of host about 5 seconds (red and blue light flashing) and release, and then long press the power button of B intercom about 5 seconds (to red and blue light flashing) and release, and then press the B button of the host, entering into the B group matching state, after pairing successful, the host and intercom B blue light flashing, matching successful, and then press the B button of the host to enter into the call state. Power off will automatically save the paired record.

3. C group match

Power on state, long press the C button of host about 5 seconds (red and blue light flashing) and release, and then long press the power button of C intercom about 5 seconds (to red and blue light flashing) and release, and then press the C button of the host, entering into the C group matching state, after pairing successful, the host and intercom C blue light flashing, matching successful, and then press the C button of the host to enter into the call state. Power off will automatically save the paired record.

4. D group match

Power on state, long press the D button of host about 5 seconds (red and blue light flashing) and release, and then long press the power button of D intercom about 5 seconds (to red and blue light flashing) and release, and then press the D button of the host, entering into the D group matching state, after pairing successful, the host and intercom D blue light flashing, matching successful, and then press the D button of the host to enter into the call state. Power off will automatically save the paired record.

5. E group match

Power on state, long press the E button of host about 5 seconds (red and blue light flashing) and release, and then long press the power button of E intercom about 5 seconds (to red and blue light flashing) and release, and then press the E button of the host, entering into the E group matching state, after pairing successful, the host and intercom E blue light flashing, matching successful, and then press the E button of the host to enter into the call state. Power off will automatically save the paired record.

【 End call 】 : Call state, just a short click on the corresponding matching “B, C, D, E, Power ” button, can end the intercom.

【 Disconnect any intercom 】 : short press PHONE can disconnect either side of the intercom.

【 E6 PLUS switch function description 】 : 1-6 intercom matching model, 1-6 machine can be as the No.1 intercom so as to pair with other equipment, can be many connections, switch function. Please pay attention to the mode when they pair, for two intercom.

【 Cancel the pairing methods 】 : Press the B key and phone key at the same time until the red and blue flashing alternatively, Pairing has been clean and to be a new state for the pairing operation.

Intercom access operation

【 Intercom access 】 :

E6 PLUS power off state, walkie-talkie plug into the USB interface, the headset can act as intercom with microphone.

Battery warning

【Low power warning】 : if the Battery is too Low, there is "BATTERY LOW" warning every 30s.

【Charging indication】 : E6 PLUS in recharged status when red light on, when full charge, red light off.

Accessories



Boom/Soft Microphone



Earphone



Clamp connected



USB line

Remote control handle



Power on : Short press the remote control phone button, red light, the remote boot.

Power off : Remote control without any operation for about 6s, the remote control automatically shut down.

Pairing with remote control handle:

In power on and standby state, long press the host E key about 6s , blue light long show , pairing with the remote control handle state. At the same time , press the remote control key to indicate that the power is normal, and then press the

remote control any two keys, until the host blue light flashes, the remote control and host pairing success.

Remote control handle control intercom's operation :

Receive calling : short press remote control handle phone call and receive calling.

Refuse calling : double press remote control (phone-key)

Calling ending : when calling , short press remote control E+ phone key.

Voice dial : power on and connect phone , fast press remote control (volume+) two times.

Last phone number dial again : power on and connect phone , fast press remote control volume two times.

Music play / Pause : short press remote control handle phone key.

Music next/Last: Playing music, fast press remote control volume + key two times , fast press volume key two times.

Add volume or down volume, short press remote control volume + remote control volume 1.

Enter / Exit connected with second intercom : short press remote control A key.

Enter / Exit connected with third intercom : short press remote control B key.

Read battery energy : at standby situation ,double press remote control phone-key.

Specification(English)

The Bluetooth specifications: Bluetooth V3.0+EDR

Power supply voltage: Battery voltage VDD: 3.7 supply

Support for Bluetooth protocol: A2DP, AVRCP, HS/HF

The temperature range: $-40^{\circ}\text{C} \sim 60^{\circ}\text{C}$

Intercom wireless transmission range: 1200m

Mobile phone connection transmitting range: 10m

Cellphone talk time: About 8 hours

Charging time: About 2 hours

Music playing time: About 8 hours

Battery type: Li-polymer 500mAh

Standby time: About 300 hours

Safety precautions:

Risk warning:

1. During the riding, any changing the setting of this product, cellphone pairing operation is prohibited in order to avoid any traffic accidents.
2. If product is smoking, hot, odour, please cut off power supply immediately, and stop using it, So as not to cause an electric shock, fire and other accidents
3. Please do not put this product into the fire, the built-in battery has the possibility of an explosion.
4. Please do not do STH without authorization remove, modification of this product, maybe will lead to product defects, and get an electric shock, fire accidents, etc.

Abnormal case handling:

Because of the water inside the product, or fall, impact and other causes of casing damaged, and abnormal voice, smoke, odour, such as abnormal happens, please immediately cut off the power and stop using it. It is strictly prohibited to disassembly and repair by customer.

Warning

1. Avoid harmful behaviors of the products, such as drop and shock, otherwise it will cause malfunction.
2. Please do not put the product near the fire or direct sunlight for a long time.
3. Keep this product away from children.
4. Using this product within -40°C to 60°C temperature environment, higher or lower than the temperature, will be no guarantee of normal using.
5. The company product accessories are verified by test, suggest use our verified accessories.

Note for charging

1. Please use our company's accessories USB cable for charging, lest cause the occurrence of smoke, fire, and so on.
2. If long time of no using this product, at least one time charge behavior every year, lest can't open the machine and the damage to the battery.
3. When charging, please use the power adapter and at room temperature, please avoid recharged in near fire place, lest cause smoke, even fire.
4. In the process of charging, Odour, burning, etc., please immediately cut off the power and stop using it. In order to avoid the smoke and fire accidents.

